

Backed by Onga's unrivalled reputation.

For more than 40 years Onga has reigned as Australia's premier brand in pumps and water products. Our reputation for offering a range of technologically advanced, innovative, durable and reliable pumps and water saving solutions is unrivalled in the industry.

A 2007 research study found that the Onga brand rated top of mind in consumer awareness. This recognition is certain to see the Onga WaterSwitch dominate the market as category leading product more Australians prefer. Backed with industry approval:

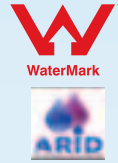

Proudly supporting
savewater.com.au



www.onga.com.au

For more information on the Onga WaterSwitch and the location of your nearest stockist, visit www.ongawaterswitch.com.au

2 Redwood Drive Notting Hill, VIC 3168
ABN 27 004 856 204

Onga WaterSwitch installation made easy.

Onga Waterswitch specifications	
Mains water connection	3/4" BSP female
Rain water connection (from Pump)	3/4" BSP female
Water outlet connection (to appliance)	3/4" BSP female
Maximum inlet pressure (Pressure reducing valve required if pressure is too high)	500 kPa
Water temperature	1C to 40C
Power Supply	240 Volt 50 Hertz 10 amps
Low voltage water level sensor	6.3mm DC plug (3 Volt)

Onga WaterSwitch Materials Checklist

- Water level sensor electrical connection
- Onga pump with quick electrical connectors
- Onga barrel union OR wall bracket (submersible versions)
- Onga WaterSwitch

Plumber Checklist

- Float set to correct height = 70mm higher than tank outlet
- Mains water "Y" strainer
- Rainwater "Y" strainer
- Isolation valve on mains water supply
- Barrel union connections on mains water and application connections
- Pressure reducing valve on mains inlet (500 kPa)
- 32mm spanner to brace fittings during pipe connection
- Barrel union connection on pump suction
- Electrical power available within 2m of Waterswitch
- Isolating valve on pump suction (tank outlet)
- Electrical switch on pump turned "ON" for SMH450 and SMH550 pumps
- Mains water is available, connected and turned "ON"

Onga WaterSwitch. Intelligent technology.

The Onga WaterSwitch is packed with smart technology and clever features to help you get more out of your tank. For example, its mains priority system conserves energy as the pump will only operate when you have rainwater in your tank. Additionally, the pump will not waste electrical energy on dripping taps.

Other features include:

- a unique water level sensor which routes in through the top of the tank - eliminating the need to drill a hole in the side.
- a solenoid valve defaults to "open" if there is a power outage or if the pump needs servicing. This means mains water is always available to your toilet or washing machine.
- a built-in dual check valve which prevents backflow and stops cross-flow contamination with your mains water supply.
- a smart LED display, making it easy to see which water source is being used and over-ride the system if necessary.
- the design accommodates mains water pressure of 500kpa for normal toilet and washing machine operations

No wonder the Onga WaterSwitch is the smarter way to save water!



Get more out of your tank with Onga WaterSwitch



www.onga.com.au

The smarter way to save precious drinking water.

With an Onga WaterSwitch attached to an ever-reliable Onga pump and rainwater tank, you are able to use your rainwater and maximise your mains water savings.



Easy for your plumber to install, the Onga WaterSwitch allows you to use rainwater for:

- flushing the toilet
- watering the garden
- topping up the pool
- washing your clothes
- washing the car or

With seven different kit options available, plus Onga's unrivalled reputation for innovation and durability, the Onga WaterSwitch is the perfect solution for managing your rainwater harvesting system and is suitable for use in both above and below ground tanks.

And with rebates available from your State Government* now is a great time to get smart and install an Onga WaterSwitch.

Smarter rain harvesting saves you money.

By using rainwater instead of mains water, you'll save money! In fact, the Onga WaterSwitch can help you save up to 35% of mains water in your toilet and laundry.#

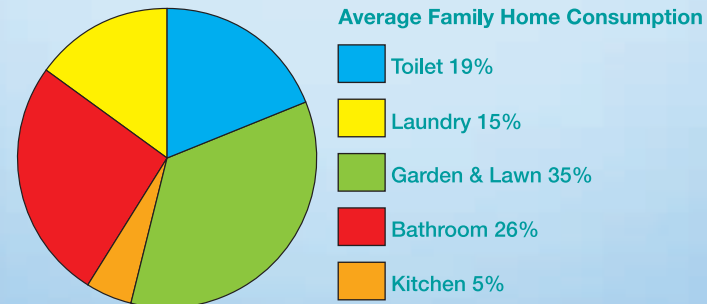

*Contact your local water authority or State Government for more information.
#Depending on size of cistern, washing machine, water tank and rainfall.

Get more out of your tank with the unique Onga WaterSwitch.

Onga WaterSwitch. How it works.

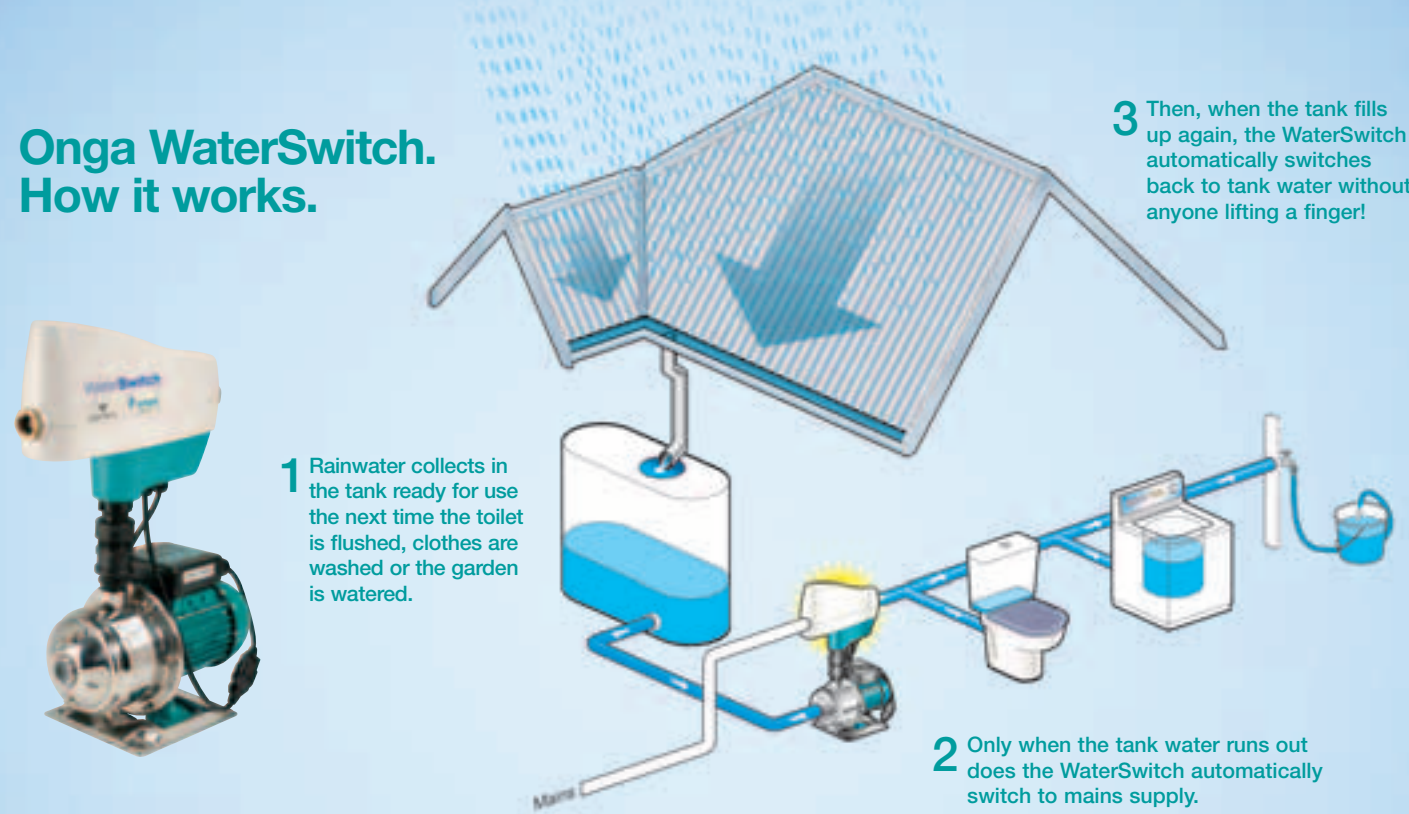

Only an Onga WaterSwitch delivers:

- savings of up to 35% of mains water in your toilet and laundry
- 7 different kit options = total installation flexibility
- ease of installation
- efficient use of rainwater
- a seamless supply of water with no mixing of tank and mains
- the peace of mind of a world-class brand
- an Australia-wide service and support network
- reduced power consumption*^



Jonathan Keren-Black

"I chose the Onga WaterSwitch because it has better features than anything else on the market. The Onga name also gave me confidence and the WaterSwitch does a brilliant job. It's great to know that I'm getting the most out of my tank and not wasting precious mains water. Best of all, it does it all automatically so there's nothing to worry about."

*compared to tank top-up systems. ^rainwater and pump energy are not used to supply dripping tanks. *the listed solutions are recommendations only and you should seek proper advice from your Onga specialist.

The Onga Quick Check selection guide

Only Onga offers seven different kits to suit any application. A discussion with the consumer about their needs and current rainwater harvesting set-up is important before recommending the correct Onga WaterSwitch kit. Here's a quick checklist to help you select the right Onga pump to team with the Onga WaterSwitch.

STEP 1 – Select single or double storey house

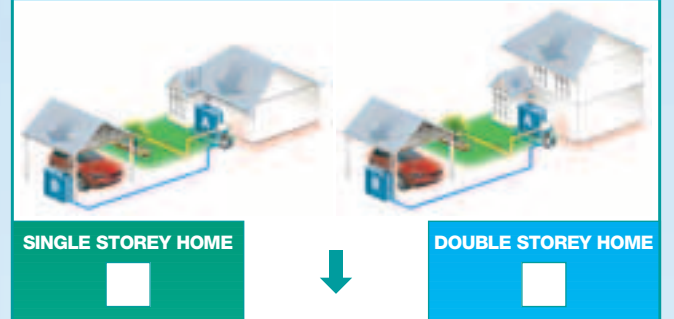

STEP 2 – Select position of tank



STEP 3 – Select number of applications you wish to run

Pump model best suited		Pump model best suited
SMHW350	*OTBW450	1 Toilet
SMHW350	*OTBW450	1 Toilet, 1 Laundry
SMHW450	*DW7535	2 Toilets, 1 Laundry
SMHW450	*DW7535	2 Toilets, 1 Laundry, 1 Garden Tap
SMHW550	*DW7556	3 Toilets, 1 Laundry, Garden Sprinklers

*Represents products that contain submersible pump combinations that can be submerged in a tank above or below ground.

Quote

Onga WaterSwitch + Onga pump model no: _____
\$ _____